



EVERLIGHT ELECTRONICS CO.,LTD.

Device Number : DLE-033-251 REV: 1.2

5.0mm Round Type LED Lamps

PART NO. : 333ID/E ECN : _____ Page: 1/4

■ Features :

- Popular T-1 3/4 diameter package.
- Choice of various viewing angles.
- Available on tape and reel.
- Reliable and robust.

■ Descriptions :

- The series is specially designed for applications requiring higher brightness
- The LED lamps are available with different colors, intensities, epoxy colors, etc.

■ Applications :

- TV set
- Monitor
- Telephone
- Computer

■ Package Dimensions:

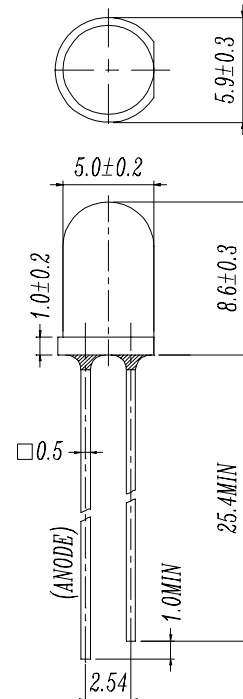

■ Notes :

- 1.All dimensions are in millimeters.
- 2.An epoxy meniscus may extend about 1.5mm(0.059") down to the lead.
- 3.Tolerances unless dimension $\pm 0.25\text{mm}$.

Umit=mm

PART NO.	Chip		Lens Color
	Material	Emitted Color	
333ID/E	GaAsP/GaP	Hi-Eff Red	Red Diffused

OFFICE : NO. 25,Lane 76,Sec.3, Chung Yang Rd., Tucheng 236, Taipei, Taiwan, R.O.C.

TEL : 886-2-2267-2000,2267-9936

FAX : 886-2-2267-6244,22676189,22676306

<http://www.everlight.com>



5.0mm Round Type LED Lamps

PART NO. : 333ID/E ECN : Page: 2/4

■ Absolute Maximum Ratings at Ta = 25°C

Parameter	Symbol	Rating	Unit
Forward Current	I _F	30	mA
Operating Temperature	T _{opr}	-40 to +85	°C
Storage Temperature	T _{stg}	-40 to +100	°C
Soldering Temperature	T _{sol}	260 ± 5	°C
Power Dissipation	P _d	100	mW
Peak Forward Current(Duty 1/10 @ 1KHZ)	I _{F(Peak)}	160	mA
Reverse Voltage	V _R	5	V

■ Electronic Optical Characteristics :

Parameter	Symbol	Min.	Typ.	Max.	Unit	Condition
Luminous Intensity	I _v	2.0	10	/	mcd	I _F = 10 mA
Viewing Angle	2θ 1/2	/	45	/	deg	I _F = 20 mA
Peak Wavelength	λ _p	/	635	/	nm	I _F = 20 mA
Dominant Wavelength	λ _d	/	625	/	nm	I _F = 20 mA
Spectrum Radiation Bandwidth	Δλ	/	45	/	nm	I _F = 20 mA
Forward Voltage	V _F	1.7	2.0	2.4	V	I _F = 20 mA
Reverse Current	I _R	/	/	10	μA	V _R = 5 V



EVERLIGHT ELECTRONICS CO.,LTD.

Device Number : DLE-033-251 REV: 1.2

5.0mm Round Type LED Lamps

PART NO. : 333ID/E ECN : _____ Page: 3/4

■ Typical Electro-Optical Characteristic Curves:

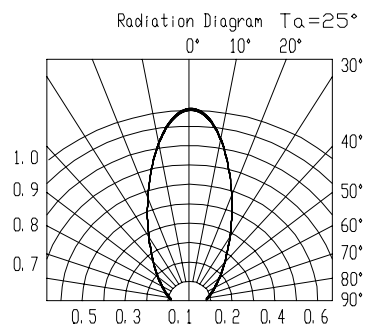
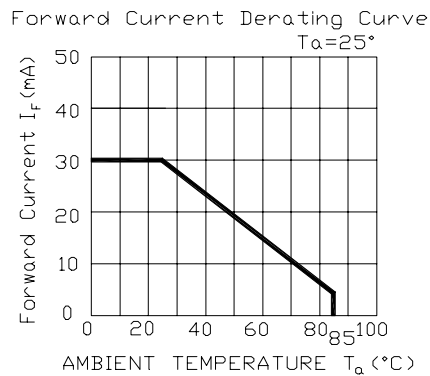
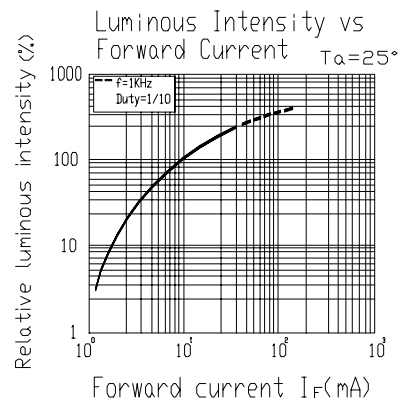
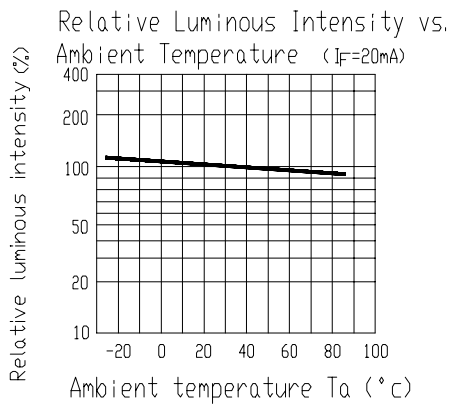
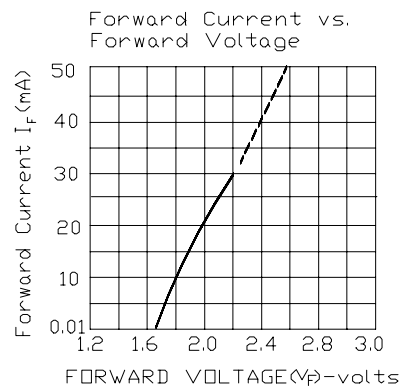
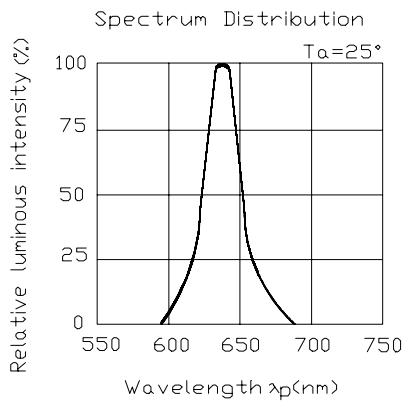



EVERLIGHT ELECTRONICS CO.,LTD.

Device Number : DLE-033-251 REV: 1.2

5.0mm Round Type LED Lamps

PART NO. : 333ID/E ECN : _____ Page: 4/4

■ Reliability test items and conditions:

No	Item	Test Conditions	Test Hours/Cycle	Sample Size	Ac/Re
1	Solder Heat	TEMP : 260°C ± 5 °C	5 SEC	76 PCS	0/1
2	Temperature Cycle	H : +85°C 30min ∫ 5 min L : -55°C 30min	50 CYCLES	76 PCS	0/1
3	Thermal Shock	H : +100°C 5min ∫ 10 sec L : -10°C 5min	50 CYCLES	76 PCS	0/1
4	High Temperature Storage	TEMP : 100°C	1000 HRS	76 PCS	0/1
5	Low Temperature Storage	TEMP : -55°C	1000 HRS	76 PCS	0/1
6	DC Operating Life	TEMP : 25°C IF=20mA	1000 HRS	76 PCS	0/1
7	High Temperature / High Humidity	85°C /85% RH	1000 HRS	76 PCS	0/1